



### 25 Camellia Place Orange NSW

4 2 2

Welcome to this stylish near new four bedroom home in North Orange close to the Botanical Gardens. The modern kitchen, dining and family room opens onto the covered alfresco so that the whole house has a bright airy feeling and an amazing view looking out to the beauty of Mount Canobolas. There is an additional formal lounge room, office and plenty of storage.

The main bedroom is spacious with a walk-in-robe and ensuite and the remaining three bedrooms all features built in robes and all rooms include ceiling fans.

Also on offer is a dishwasher, walk-in pantry gas cook top and electric oven in the kitchen, ducted gas heating/cooling, double garage with internal access and remote door.

**Type** : House

**View** : <https://www.johncook.com.au/lease/nsw/central-west/orange/residential/house/8144017>



**Jane Cook**  
02 6361 0133

[For full version visit the website](https://www.johncook.com.au)

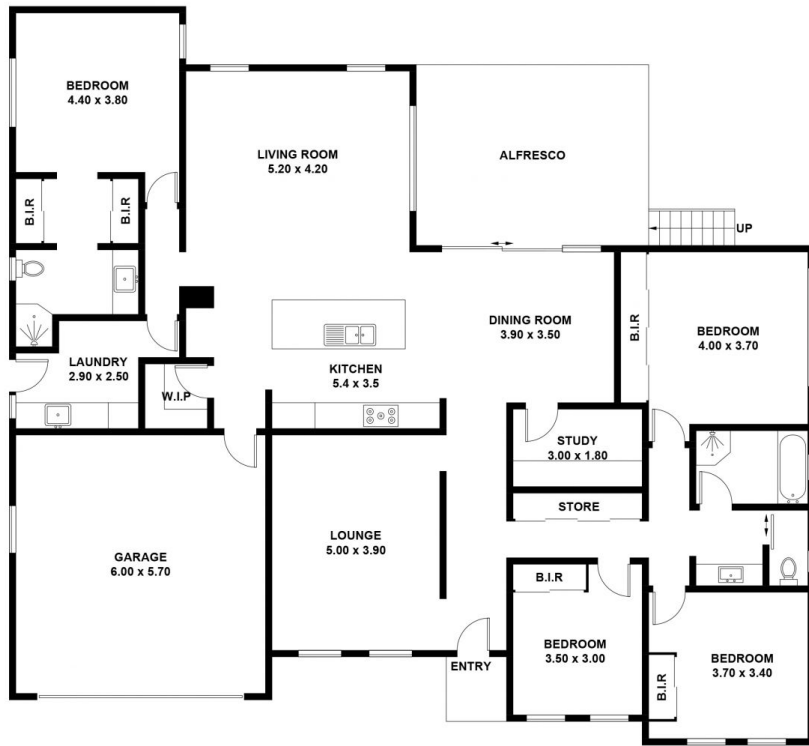

This plan is for layout guidance only. Not drawn to scale unless stated.  
Windows and door openings are approximate. Whilst every care is taken in the preparation of this plan,  
please check all dimensions, shapes and compass bearings before making any decisions reliant upon them.